



# butech

PORCELANOSA Grupo

## Contrast in black

The Black and Texture collections by Butech highlight the PORCELANOSA tile finishes with the maximization of contrast

# Black Collection

Contrast between light-coloured wall tiles and bathroom accessories is among the most popular trends in decoration, specially when black taps and shower columns are involved.

To add value to these designs, Butech presents the **Black** profiles collection, made of the highest quality aluminium which becomes the perfect surface to receive an outstanding matt black finish. Decoration lines and corners using these profiles are perfectly integrated with tiles and bathroom accessories.





## pro-part black

**pro-part black** is the greatest exponent of matt black decoration, making it essential in bathrooms with dark-coloured taps and accessories, even more so with glossy tiles, where the smooth surface of the **pro-part black** shines on its own way and blends in perfectly.

This profile, with an 8 mm visible side and made of high-grade aluminium, is used on walls for a wide range of situations such as decorative lines, corners or transitions between different tile collections.

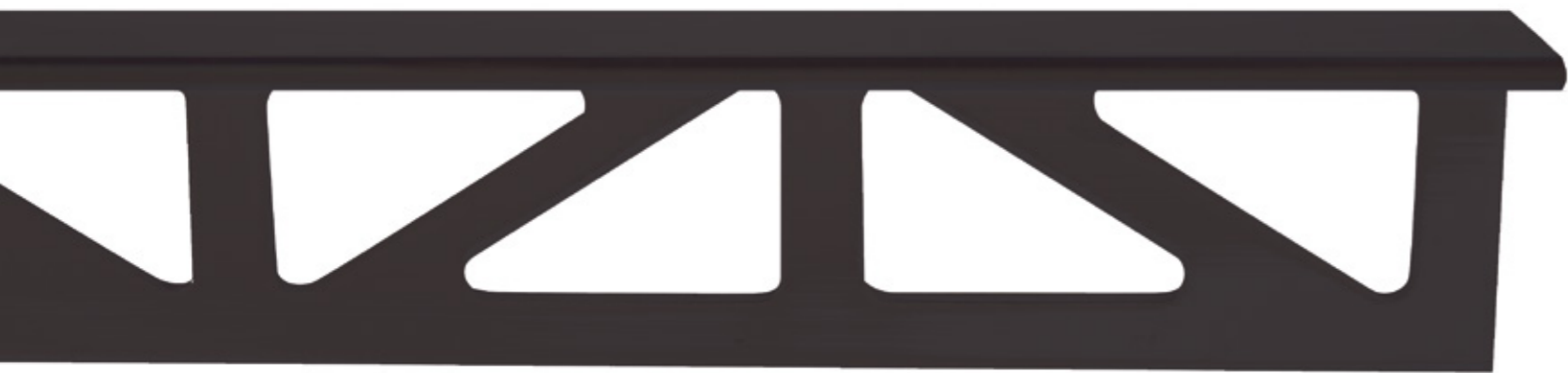

## pro-mate 3 black

Right angle profile designed to cover the edges of tiles in corners and transitions to painted walls. Its jet-black finish can be combined both with tile series inspired by dark stones and marbles, and in bathrooms with accessories in the same black colour.

With a visible side just 3mm wide, this subtle straight line is the most minimalistic option for protecting the undecorated edge of ceramic tiles.



# Texture Collection

Texture profiles illustrate a new step in the evolution of tile decoration. In addition to colour, touch becomes a fundamental element of the profile design. This collection has been created to be combined with the latest trends in tiles, and especially those ones with the predominance of matt shades, textured appearance or surface relief.

Made of high-performance brass, this collection can be used on both floors and walls with no risk of oxidation.

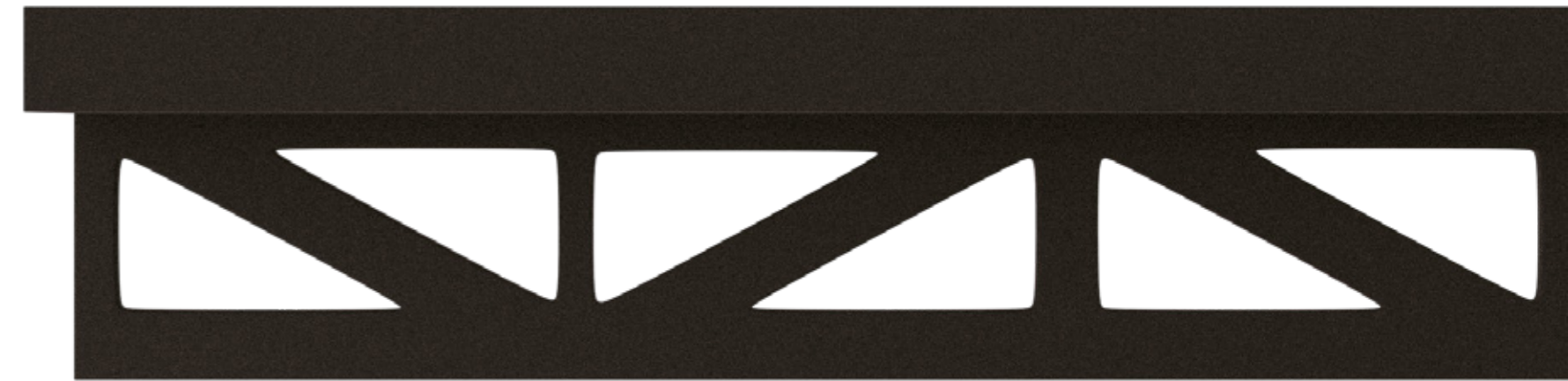

## pro-part coal

The absolute black of this profile absorbs the most current trends in bathroom design: black furniture and accessories that contrast with the whitest tile collections.

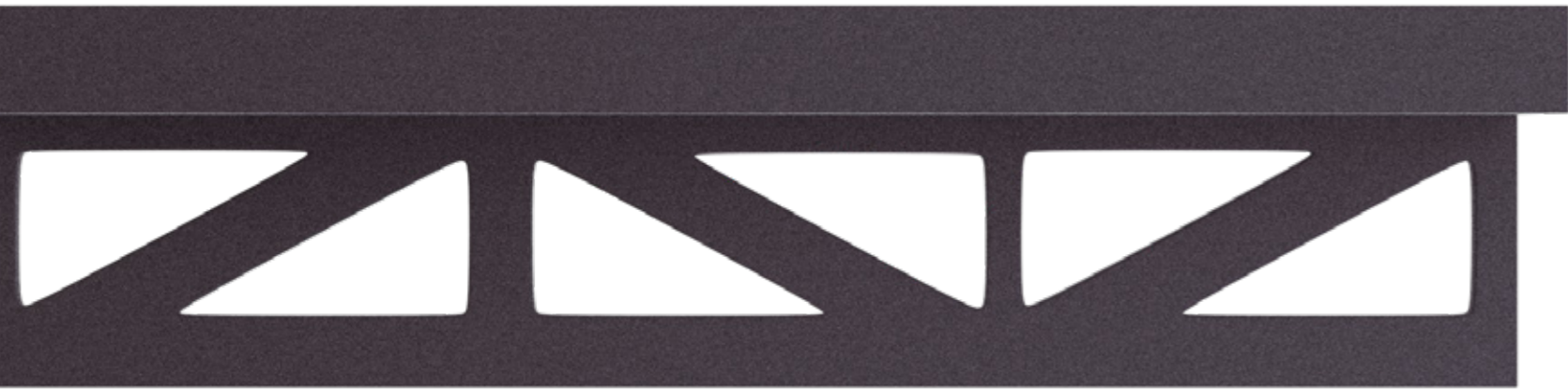

## pro-part cast iron

Cast iron inspires this industrial-looking profile, designed both to harmonize with dark-shaded tiles and to contrast with light-colored patterns. Perfect combination with some metal finishes from Gama-decor.





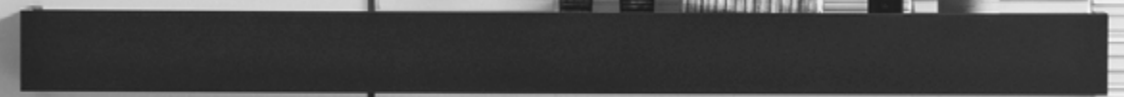

# Flooring

The **Texture** profiles can also be used on interior design in combination with floor tiles. Framing, protection of steps or separation of spaces are some of the applications of this collection that, featuring a high resistance to wear, become an extremely valued element in the decoration of floors.





# Walls

The **Black** and **Texture** profiles replace the traditional borders and listellos used in ceramic decoration. When the design of wall tiles needs a decorative horizontal or vertical line or framing, these collections become an unique choice.

# Corners

In wall tiles, it is absolutely essential to protect and cover the corners. The **Black** and **Texture** profiles offer a perfect finish with all types of tiles, including rectified ones, whilst at the same time being highly resistant to impact and providing security and decoration.





# Niches and shelves

The design of bathrooms often includes shelves and niches covered with tiles, making the use of profiles essential to finish off the corners. When the bathroom decoration is based on dark elements, the **Black** and **Texture** profiles are always the best choice.

# Wet areas

Resistance to contact and action of water is one of the main characteristics of the **Black** and **Texture** profiles, allowing their use in kitchens, bathrooms, shower areas and steam rooms.







Made of extruded aluminium, the **pro-mate 3** and **pro-part Black** profiles provide a high-quality finish and superior resistance when used in walls.

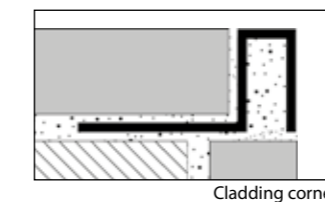
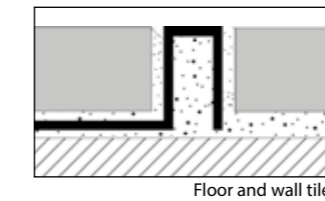
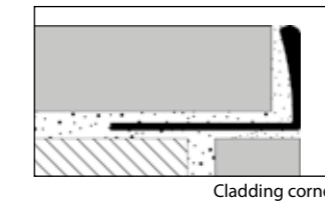
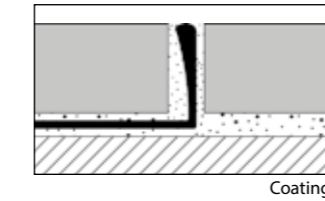

Profile description	Height	Code
pro-mate 3 black	8 mm	100220142
	10 mm	100171991
	12,5 mm	100220132

Profile description	Height	Code
pro-part black	7 mm	100220100
	11 mm	100171975
	12,5 mm	100220083



Made of extruded brass, the **Texture** profiles provide the highest possible quality finish and top resistance, suitable for both floors and walls.

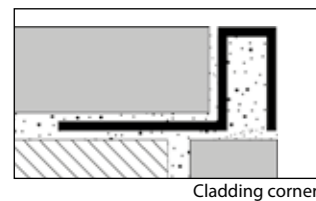
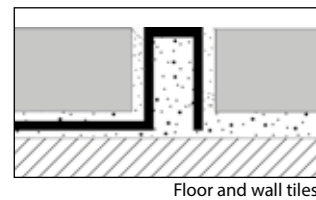

Profile description	Height	Code
pro-part coal	7 mm	100278697
	9 mm	100326478
	11 mm	100269081
pro-part cast iron	12,5 mm	100278751
	7 mm	100285068
	9 mm	100326516
	11 mm	100222994
	12,5 mm	100278717





BY APPOINTMENT TO  
H.R.H. THE PRINCE OF WALES  
MANUFACTURER AND DISTRIBUTOR  
OF CERAMIC TILES AND BUILDING PRODUCTS.  
PORCELANOSA GROUP LIMITED

**butech**  
PORCELANOSA Grupo

**butech building technology, s.a.u.**  
Ctra. Vila-real - Puebla de Arenoso (CV-20), Km. 2.5 · Apartado de Correos 297 · 12540 Vila-real, Castellón - Spain.  
Teléfono (+34) 964 53 62 00 · Fax: (+34) 964 53 00 34 · E-mail: [butech@butech.es](mailto:butech@butech.es) · [www.butech.net](http://www.butech.net)